

## VILLA - FACT SHEET

Elela Villa & The Reserve Pg1 | Architectural Layouts Pg2 | Reference Table Pg3

Elela Villa | Tel: +27 (0)18 350 9902 | Email: res@madikwesafarilodge.co.za

### About the Lodge

Located in the pristine expanse of Madikwe Safari Lodge, the Elela Villa is a testament to exquisite luxury amid South Africa's captivating wild. Inspired by the Tswana term signifying "to flow, as water," this distinguished three-bedroom sanctuary marries the region's profound heritage with an unmatched opulence. Every facet of its design reflects a harmonious blend of the grand and the intimate. As guests step into its confines, they are welcomed by an ambiance that resonates with the land's spirit. This villa doesn't just offer a stay; it promises an immersive experience, redefining the essence of exclusivity in a game lodge setting.

### Villa Features

- Main lodge viewing/dining deck
- Fire terrace, hosting fireside drinks under the stars
- Indoor dining room, with a fireplace
- Guest lounge, with a fireplace
- Access to the new wellness centre (spa)
- Complimentary Wi-Fi – but we recommend reconnecting with each other
- Madikwe Safari Lodge Gallery (at Lelapa Lodge), retailing rare and beautiful keepsakes, as well as everyday essentials

### Location

Elela Villa, Madikwe Safari Lodge is located in the central-eastern region of Madikwe Game Reserve. The area surrounding the lodge is well known for its rich biodiversity and provides some of the best game-viewing opportunities on the reserve.

GPS co-ordinates: should not be followed as these may get guests lost and most recommended routes are not navigable by normal vehicle.

### Weather

Average maximum temperatures range from 23°C/73°F in July to 40°C/104°F in January, with the lowest average minimum occurring in July at 2°C/36°F • The region is semi-arid, with an average annual rainfall of 500mm (20in), occurring mostly during the summer months (December -February) • Rain is usually in the form of thundershowers, where a downpour is experienced, very seldom lasting longer than a few hours

### Best Time to Travel

A year-round safari destination • The animals in Madikwe Game Reserve are non-migratory, and variation in the safari experience is season rather than location related • The best period for birdwatching is from October to April

### Health Info: Malaria

Elela, Madikwe Safari Lodge is situated in a region of South Africa that is not inhabited by the malaria-carrying mosquito (Anopheles) and is therefore classified MALARIA FREE.

**Elela Villa Layout**

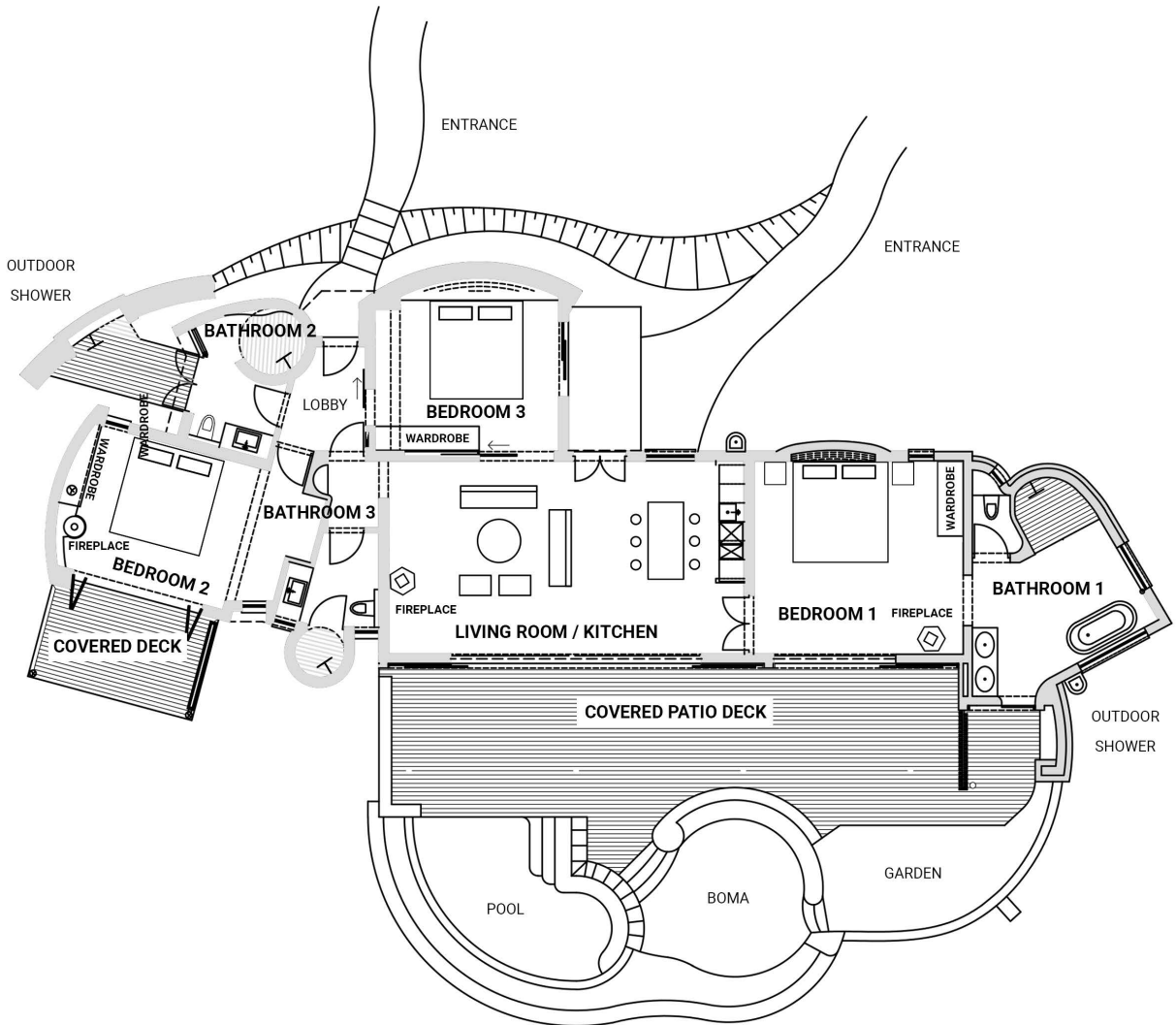
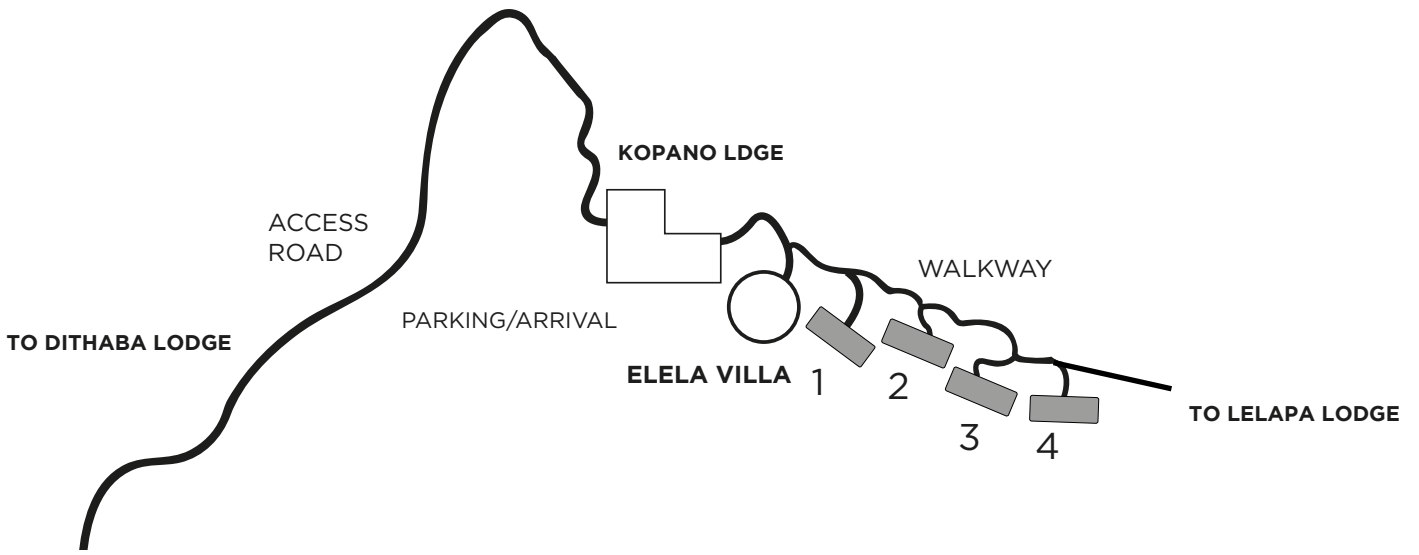

## Reference Table - Elela Villa

Reference	Elela Villa
Bedrooms	3 Bedroom Villa
Size of villa	210m <sup>2</sup> /2260ft <sup>2</sup>
Guests	6
Children	>12
Children's rate	<5 (free) 6 to 15 (50% of adult rate)
Safari Drives	Private game drive
Children activities	Yes
Childminding	Yes
Triple rooms (sleeper couch)	0
Single traveller supplement	No
Double bed convertible to twin	Yes
Central guest pool	No
Air conditioning	Yes
Fireplace	Yes
Room fans	Yes
Mosquito nets	No
Outdoor shower	Yes
Indoor showers	Yes
Separate WC	Yes
Free Wi-Fi	Yes
Satellite television	No
In-room telephone	Yes (direct dial)
Mobile coverage	Average: 60% (MTN/Vodacom)
In-room safe	Yes
Minibar	Yes
Hairdryer	Yes
Laundry	Yes (additional cost)
Conference facilities	No
Spa facilities	Yes
Gym facilities	Yes - 'Gym in a Basket' & access to gym at <i>Lelapa</i>
Suitable for disabled guests	No
Airstrip	Yes (15 minutes away) 24°44'0"S   26°24'25"E
Helipad	Yes (24°43'11.8"S   26°23'4.2"E)
Guests per open safari vehicle	6
Private open safari vehicle	Yes
Languages of field rangers	English
Gratuity recommendation	ZAR1200* per guest per day *Specific allocations clarified on request
Kosher dining	Yes (with prior notice, at an additional cost)
Power	220V AC
Credit cards	Mastercard, Visa, Amex
Cheques	Not accepted